

SITE PLAN

YOU MAY USE THE FOLLOWING BLANK PAGE FOR YOUR SITE PLAN. AT MINIMUM, USE A RULER AND SHOW DIMENSIONS OF ALL SETBACKS, LOT LINES AND BUILDINGS. ILLEGIBLE SITE PLANS ARE NOT ACCEPTABLE.

WHAT MUST BE SHOWN:

- 1. North Arrow
- 2. Property lines and dimensions of the property
- 3. All adjacent edge of rights-of-way, public rights-of-way and their names
- 4. Existing and proposed structures, their sizes and distances from property lines, and edge of right-of-way
- 5. Existing and proposed signs, their sizes and distance from property lines and edge of right-of-way
- 6. Existing and proposed parking areas and/or parking spaces, their sizes and distances from property lines and edge of right-of-way
- 7. Existing and proposed outside storage and/or outside display areas, their sizes and distances from property lines and edge of right-of-way
- 8. Existing and proposed buffering (ie: fences, trees, mounds) their sizes and distances from property lines and edge of right-of-way
- 9. Structures, signs or screening (fences, trees, etc.) proposed to be demolished or removed

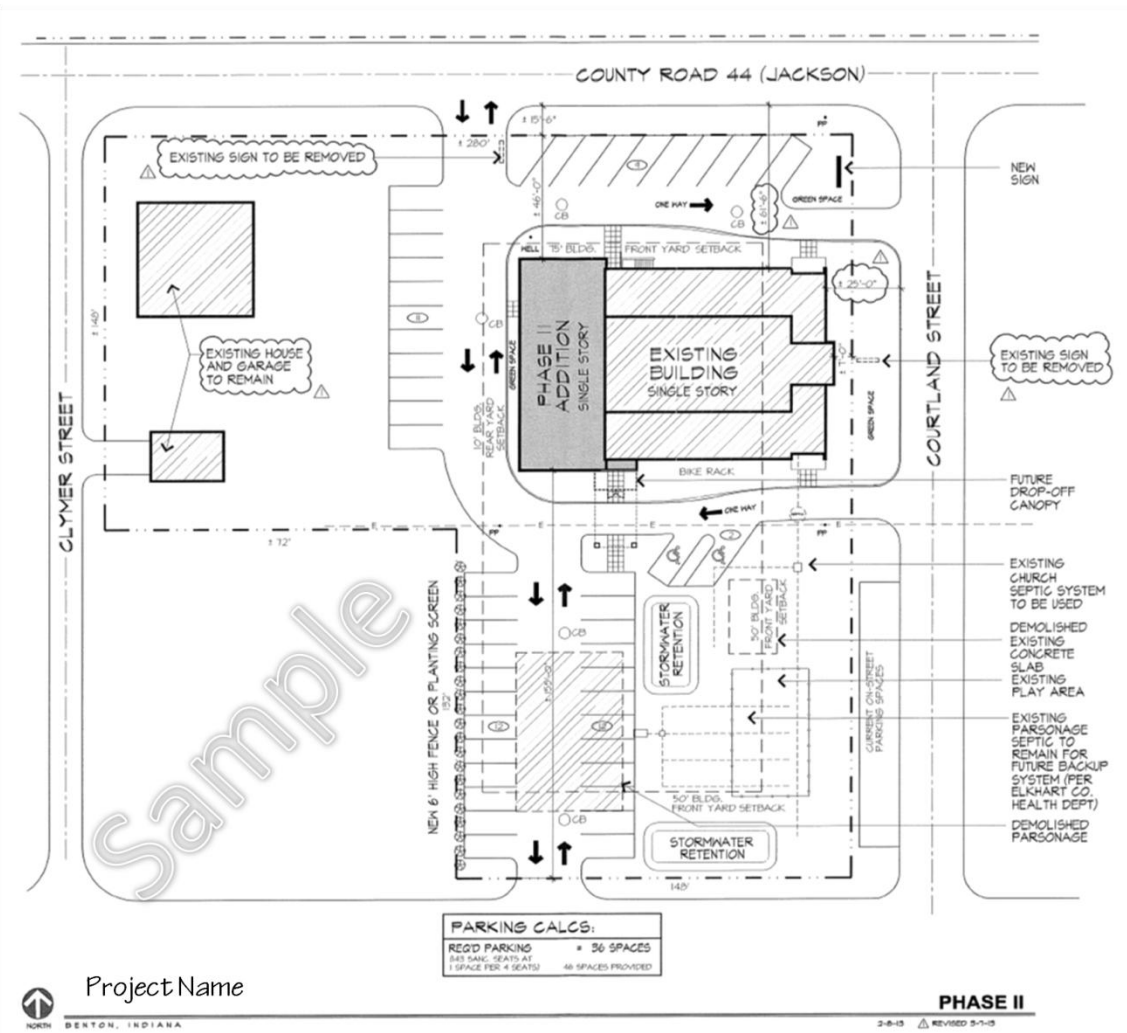

The submitted site plan is a fair and accurate representation of my property and petition.

Name _____

Date _____

THIS SITE PLAN MUST ACCOMPANY YOUR APPLICATION. IF THE APPLICATION DOES NOT INCLUDE THE COMPLETED SITE PLAN, IT WILL BE CONSIDERED INCOMPLETE AND THE STAFF WILL NOT ACCEPT THE APPLICATION.

MORE DETAILED DRAWINGS WILL BE REQUIRED IN ORDER TO APPLY FOR STATE RELEASE, AN IMPROVEMENT LOCATION PERMIT OR BUILDING PERMIT.

